

## TASSO-M20

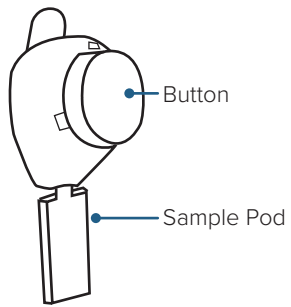

## VIDEO

**FIRST TIME USERS**  
Point your phone's camera here to watch:



or go to  
[www.tassoinc.com/tasso-m20-video](http://www.tassoinc.com/tasso-m20-video)

## PREPARE

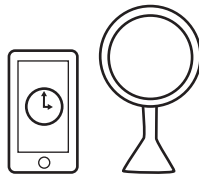

**1. Get a timer and mirror.**

You'll need them during collection.



**2. Rub arm quickly and firmly just below the shoulder.**

Rub until it's very warm to help your blood flow.



**3. Clean arm with alcohol pad.**

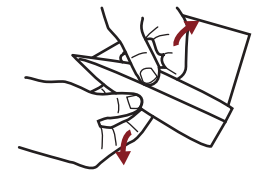

**4. Open device pouch by pulling apart white and clear layers.**

## COLLECT

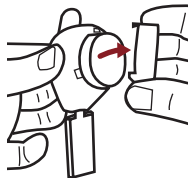

**5. Remove clear plastic cover over the red button.**

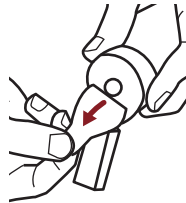

**6. Peel paper tab behind the red button.**

Keep sample pod pointing down.

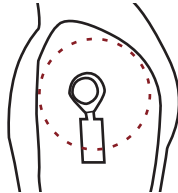

**7. Stick device to shoulder.**

Do not remove once it's on.

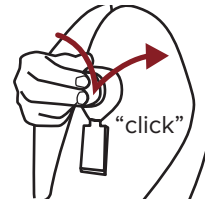

**8. Press button quickly and firmly until it can't go any farther. Wait two seconds then let go.**

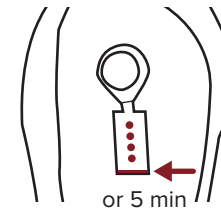

**9. Start a five minute timer.**

Keep arm at your side and watch dots fill with a mirror. You won't see blood right away.

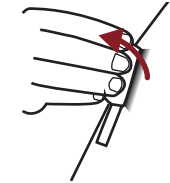

**10. After five minutes or earlier if blood appears at the bottom of the pod, peel off device.**

## RETURN



**11. Peel off the clear film to expose the sample pod vent.**

Apply barcode label to back of pod if provided.



**12. Place device in the foil return bag and seal.**

Leave the moisture packs in the bag.

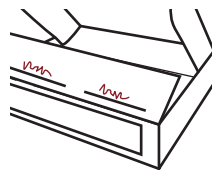

**13. Write collection date and time on the inside flap of the box.**



**14. Place bag in box and seal with the strip.**



**15. Follow provided instructions to return your sample to the lab.**

## INSTRUCTIONS FOR USE

# TASSO ONDEMAND

## TASSO-M20



☐ Contact us for help:  
1-800-257-2370

Tasso, Inc.  
400 2nd Ave W.  
Seattle, WA 98119 USA



**EC REP**  
EMERGO EUROPE  
Westervoortsewijk 60,  
6827 AT Arnhem  
The Netherlands



MedEnvoy  
Prinses Margrietplantsoen 33 - Suite 123  
2595 AM The Hague  
The Netherlands

PN0204-01\_05

### TRANSLATED INSTRUCTIONS

- The Tasso-M20 instructions for use and translations can be found on the Tasso website:
- Die Gebrauchsanweisungen für Tasso M20 und Übersetzungen finden Sie auf der Tasso-Website:
- Las instrucciones de uso del Tasso-M20 y las traducciones se pueden encontrar en el sitio Web de Tasso:
- Le istruzioni per l'uso di Tasso-M20 e le relative traduzioni sono reperibili sul sito web di Tasso:
- Le mode d'emploi du Tasso-M20 et ses traductions sont disponibles sur le site web de Tasso:
- De gebruiksinstructies en vertalingen voor de Tasso-M20 vindt u op de Tasso-website:
- Användningsinstruktioner och översättningar för Tasso-M20 finns på Tassos webbplats:
- As instruções de uso do Tasso-M20 e as traduções estão disponíveis no site da Tasso:
- Instrukcije obsjuge Tasso-M20 oraz tłumaczenia można znaleźć na stronie internetowej Tasso:
- Указания за употреба и преводите на Tasso-M20 могат да бъдат намерени на Интернет страницата на Tasso:
- Návod k použití a překlady Tasso-M20 naleznete na webových stránkách společnosti Tasso:
- A Tasso-M20 használati útmutatója és annak fordítása megtalálható a Tasso weboldalon:
- Tasso-M20の使用方法説明書と翻訳は、Tasso社のウェブサイトに掲載されています:
- Tasso-M20使用说明和译文可在Tasso网站上找到:
- Инструкция за експлуатация до Tasso-M20 ризними мовами знаходиться на веб-сайті компанії Tasso:
- Инструкция по эксплуатации к Tasso-M20 на разных языках находится на сайте компании Tasso:
- Návod na použití zariadenia Tasso-M20 a preklady zariadenia Tasso-M20 a preklady nájdete na webovej stránke Tasso:

<https://www.tassoinc.com/tasso-m20-ifu>

### INTENDED USE

The Tasso-M20 is used to collect, store, and transport capillary blood for testing in a centralized laboratory. It is to be used in non-clinical settings for use in adult populations.

### DEVICE DESCRIPTION

The Tasso-M20 is a sterile, disposable, integrated collection device. It consists of a Button and Sample Pod. The Button is covered by a removable cap. A peel off paper back is removed prior to sampling. After collecting the sample the device will be delivered to a centralized laboratory for analysis. A return bag with absorbent pad is provided in the kit.

### STORAGE AND STABILITY

The Tasso-M20 should be stored at room temperature 18°C – 28°C (64°F – 82°F) and can be used until the expiration date. The samples are shipped at ambient temperature using the provided shipping materials.

### PRINCIPLES OF OPERATION

When collecting a sample, the device is placed onto the skin of the upper arm for a couple of minutes. A sterile needle punctures skin and the Button draws capillary blood into the Sample Pod using vacuum. After a pre-defined time period or when the Sample Pod is full, the device is removed and delivered to the laboratory. Follow the detailed instructions during use.

### KIT CONTENTS

Tasso Blood Collection Device  
Alcohol Wipe  
Bandage  
Return Bag with Absorbent Pad  
Instructions for Use

### CONTRAINDICATIONS

• Not for use on infant heels.

### DISPOSAL

Defective devices to be disposed of according to local or state guidelines for disposal of used sharps.

### CAUTIONS & WARNINGS

- Prescription use only.
- For In Vitro Diagnostic Use.
- Do not resterilize.
- Do not use if pouch has been opened or damaged.
- Do not use after expiration date.
- Do not use only.
- Single use only.
- Minor bruising may occur around the sample collection site.
- Use while seated as fainting may occur with any blood sampling procedure.
- Observe universal biological risk precautions.
- Keep out of reach of children.

### SYMBOLS

- REF** Catalog number
- LOT** Lot number
- Use by date
- Consult instructions for use
- This device contains sharps
- Do not use if package is damaged
- Single use only
- Do not resterilize
- Biological risk
- Store at 18-28°C
- Transport at 25-85% RH
- CE Mark
- Rx ONLY** Prescription use only
- STERILE R** Sterilized by irradiation
- Importer