

TASSO-M20

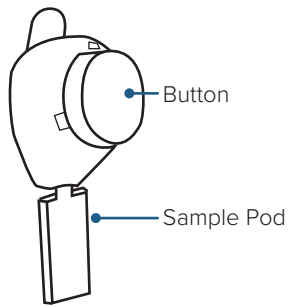

VIDEO

FIRST TIME USERS
Point your phone's camera here to watch:

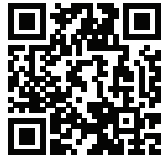

or go to
www.tassoinc.com/tasso-m20-video

PREPARE

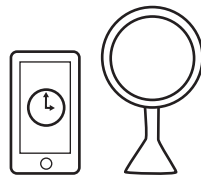

1. Get a timer and mirror.

You'll need them during collection.



2. Rub arm quickly and firmly just below the shoulder.

Rub until it's very warm to help your blood flow.



3. Clean arm with alcohol pad.

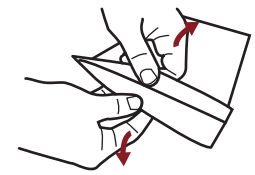

4. Open device pouch by pulling apart white and clear layers.

COLLECT

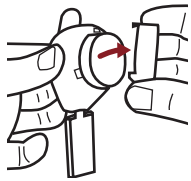

5. Remove clear plastic cover over the red button.

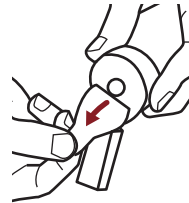

6. Peel paper tab behind the red button.

Keep sample pod pointing down.

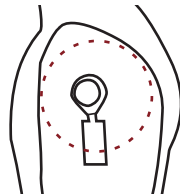

7. Stick device to shoulder.

Do not remove once it's on.

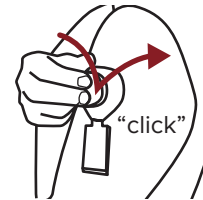

8. Press button quickly and firmly until it can't go any farther. Wait two seconds then let go.

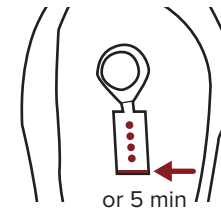

9. Start a five minute timer.

Keep arm at your side and watch dots fill with a mirror. You won't see blood right away.

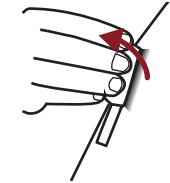

10. After five minutes or earlier if blood appears at the bottom of the pod, peel off device.

RETURN



11. Peel off the clear film to expose the sample pod vent.

Apply barcode label to back of pod if provided.

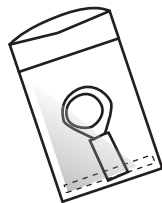

12. Place device in the foil return bag and seal.

Leave the moisture packs in the bag.

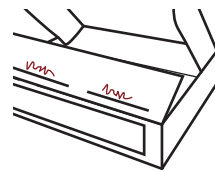

13. Write collection date and time on the inside flap of the box.



14. Place bag in box and seal with the strip.



15. Follow provided instructions to return your sample to the lab.



Contact us for help:
1-800-257-2370

TASSO ONDEMAND TASSO-M20

INSTRUCTIONS FOR USE



TRANSLATED INSTRUCTIONS

- The Tasso-M20 instructions for use and translations can be found on the Tasso website:
- Die Gebrauchsanweisungen für Tasso M20 und Übersetzungen finden Sie auf der Tasso-Website:
- Las instrucciones de uso del Tasso-M20 y las traducciones se pueden encontrar en el sitio Web de Tasso:
- Le istruzioni per l'uso di Tasso-M20 e le relative traduzioni sono reperibili sul sito web di Tasso:
- Le mode d'emploi du Tasso-M20 et ses traductions sont disponibles sur le site web de Tasso:
- De gebruiksinstructies en vertalingen voor de Tasso-M20 vindt u op de Tasso-website:
- Användningsinstruktioner och översättningar för Tasso-M20 finns på Tassos webbplats:
- As instruções de uso do Tasso-M20 e as traduções estão disponíveis no site da Tasso:
- Instrukcję obsługi Tasso-M20 oraz tłumaczenia można znaleźć na stronie internetowej Tasso:
- Указания за употреба и преводите на Tasso-M20 могат да бъдат намерени на Интернет страницата на Tasso:
- Návod k použití a překlady k zařízení Tasso-M20 naleznete na webových stránkách společnosti Tasso:
- A Tasso-M20 használati útmutatója és annak fordítása megtalálható a Tasso weboldalán:
- Tasso-M20の使用説明書と翻訳は、Tasso社のウェブサイトに掲載されています:
- Tasso-M20使用说明书和译文可在Tasso网站上找到:
- Інструкція з експлуатації до Tasso-M20 різними мовами знаходиться на веб-сайті компанії:
- Инструкция по эксплуатации к Tasso-M20 на разных языках находится на веб-сайте компании Tasso:
- Návod na použitie zariadenia Tasso-M20 a preklady nájdete na webovej stránke Tasso:

<https://www.tassoinc.com/tasso-m20-ifu>

Tasso, Inc.
400 2nd Ave W.
Seattle, WA 98119 USA

EC REP EMERGO EUROPE
Westervoortsedijk 60,
6827 AT Arnhem
The Netherlands



MedEnvoy
Prinses Margrietplantsoen 33 - Suite 123
2595 AM The Hague
The Netherlands

PN0204-01_06

INTENDED USE

The Tasso-M20 is used to collect, store, and transport capillary blood for testing in a centralized laboratory. It is to be used in non-clinical settings for use in adult populations.

DEVICE DESCRIPTION

The Tasso-M20 is a sterile, disposable, integrated collection device. It consists of a Button and Sample Pod. The Button is covered by a removable cap. A peel off paper back is removed prior to sampling. After collecting the sample the device will be delivered to a centralized laboratory for analysis. A return bag with absorbent pad is provided in the kit.

STORAGE AND STABILITY

The Tasso-M20 should be stored at room temperature 18°C – 28°C (64°F – 82°F) and can be used until the expiration date. The samples are shipped at ambient temperature using the provided shipping materials.

PRINCIPLES OF OPERATION

When collecting a sample, the device is placed onto the skin of the upper arm for a couple of minutes. A sterile needle punctures skin and the Button draws capillary blood into the Sample Pod using vacuum. After a pre-defined time period or when the Sample Pod is full, the device is removed and delivered to the laboratory. Follow the detailed instructions during use.

KIT CONTENTS

Tasso Blood Collection Device
Alcohol Wipe
Bandage
Return Bag with Absorbent Pad
Instructions for Use

CONTRAINDICATIONS

- Not for use on infant heels.

DISPOSAL

Defective devices to be disposed of according to local or state guidelines for disposal of used sharps.

CAUTIONS & WARNINGS

- Prescription use only.
- For In Vitro Diagnostic Use.
- Do not resterilize.
- Do not use if pouch has been opened or damaged.
- Do not use after expiration date.
- Single use only.
- Minor bruising may occur around the sample collection site.
- Use while seated as fainting may occur with any blood sampling procedure.
- Observe universal biological risk precautions.
- Keep out of reach of children.

SYMBOLS

- REF Catalog number
- LOT Lot number
- Use by date
- Consult instructions for use
- This device contains sharps
- Do not use if package is damaged
- Single use only
- Do not resterilize
- Biological risk
- Store at 18-28°C
- Transport at 25-85% RH
- CE Mark
- Rx ONLY Prescription use only
- STERILE R Sterilized by irradiation
- Importer