

TASSO-M20

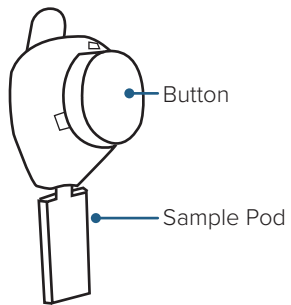

VIDEO

FIRST TIME USERS
Point your phone's camera here to watch:



or go to
www.tassoinc.com/tasso-m20-video

PREPARE

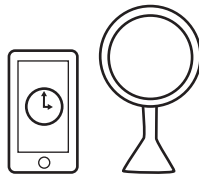

1. Get a timer and mirror.

You'll need them during collection.



2. Rub arm quickly and firmly just below the shoulder.

Rub until it's very warm to help your blood flow.



3. Clean arm with alcohol pad.

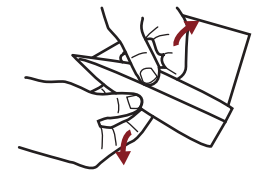

4. Open device pouch by pulling apart white and clear layers.

COLLECT

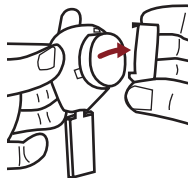

5. Remove clear plastic cover over the red button.

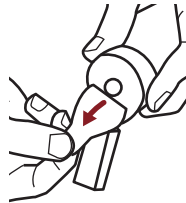

6. Peel paper tab behind the red button.

Keep sample pod pointing down.

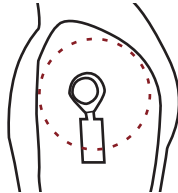

7. Stick device to shoulder.

Do not remove once it's on.

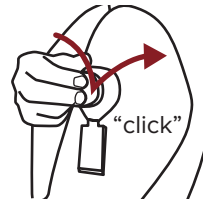

8. Press button quickly and firmly until it can't go any farther. Wait two seconds then let go.

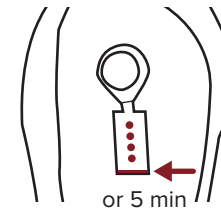

9. Start a five minute timer.

Keep arm at your side and watch dots fill with a mirror. You won't see blood right away.

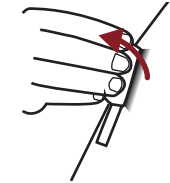

10. After five minutes or earlier if blood appears at the bottom of the pod, peel off device.

RETURN



11. Peel off the clear film to expose the sample pod vent.

Apply barcode label to back of pod if provided.



12. Place device in the foil return bag and seal.

Leave the moisture packs in the bag.

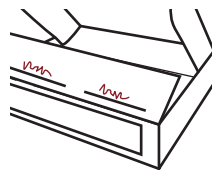

13. Write collection date and time on the inside flap of the box.



14. Place bag in box and seal with the strip.



15. Follow provided instructions to return your sample to the lab.



INSTRUCTIONS FOR USE

**TASSO ONDEMAND
TASSO-M20**



- TRANSLATED INSTRUCTIONS**
- The Tasso-M20 instructions for use and translations can be found on the Tasso website:
 - Die Gebrauchsanweisungen für Tasso M20 und Übersetzungen finden Sie auf der Tasso-Website:
 - Las instrucciones de uso del Tasso-M20 y las traducciones se pueden encontrar en el sitio Web de Tasso:
 - Le istruzioni per l'uso di Tasso-M20 e le relative traduzioni sono reperibili sul sito web di Tasso:
 - Le mode d'emploi du Tasso-M20 et ses traductions sont disponibles sur le site web de Tasso:
 - De gebruiksinstructies en vertalingen voor de Tasso-M20 vindt u op de Tasso-website:
 - Användningsinstruktioner och översättningar för Tasso-M20 finns på Tassos webbplats:
 - As instruções de uso do Tasso-M20 e as traduções estão disponíveis no site da Tasso:
 - Instrukcije obsjuge Tasso-M20 oraz tłumaczenia można znaleźć na stronie internetowej Tasso:
 - Указанията за употреба и преводите на Tasso-M20 могат да бъдат намерени на Интернет страницата на Tasso:
 - Návod k použití a překlady Tasso-M20 naleznete na webových stránkách společnosti Tasso:
 - A Tasso-M20 használati útmutatója és annak fordítása megtalálható a Tasso weboldalon:
 - Tasso-M20の使用方法と翻訳は、Tasso社のウェブサイトに掲載されています:
 - Tasso-M20使用说明书和译文可在Tasso网站上找到:
 - Инструкция за експлуатация до Tasso-M20 ризиними мовами знаходиться на веб-сайті компанії Tasso:
 - Инструкция по эксплуатации к Tasso-M20 на разных языках находится на сайте компании Tasso:
 - Návod na použití zariadenia Tasso-M20 a preklady zariadenia Tasso-M20 a preklady stránke Tasso:

<https://www.tassoinc.com/tasso-m20-ifu>

INTENDED USE
The Tasso-M20 is used to collect, store, and transport capillary blood for testing in a centralized laboratory. It is to be used in non-clinical settings for use in adult populations.

DEVICE DESCRIPTION
The Tasso-M20 is a sterile, disposable, integrated collection device. It consists of a Button and Sample Pod. The Button is covered by a removable cap. A peel off paper back is removed prior to sampling. After collecting the sample the device will be delivered to a centralized laboratory for analysis. A return bag with absorbent pad is provided in the kit.

STORAGE AND STABILITY
The Tasso-M20 should be stored at room temperature 18°C – 28°C (64°F – 82°F) and can be used until the expiration date. The samples are shipped at ambient temperature using the provided shipping materials.

PRINCIPLES OF OPERATION
When collecting a sample, the device is placed onto the skin of the upper arm for a couple of minutes. A sterile needle punctures skin and the Button draws capillary blood into the Sample Pod using vacuum. After a pre-defined time period or when the Sample Pod is full, the device is removed and delivered to the laboratory. Follow the detailed instructions during use.

KIT CONTENTS
Tasso Blood Collection Device
Alcohol Wipe
Bandage
Return Bag with Absorbent Pad
Instructions for Use

CONTRAINDICATIONS
• Not for use on infant heels.

DISPOSAL
Defective devices to be disposed of according to local or state guidelines for disposal of used sharps.

CAUTIONS & WARNINGS

- Prescription use only.
- For In Vitro Diagnostic Use.
- Do not resterilize.
- Do not use if pouch has been opened or damaged.
- Do not use after expiration date.
- Single use only.
- Minor bruising may occur around the sample collection site.
- Use while seated as fainting may occur with any blood sampling procedure.
- Observe universal biological risk precautions.
- Keep out of reach of children.

SYMBOLS

- REF** Catalog number
- LOT** Lot number
- Use by date**
- Consult instructions for use**
- ⚠** This device contains sharps
- Do not use if package is damaged**
- Single use only**
- Do not resterilize**
- Biological risk**
- Store at 18-28°C**
- Transport at 25-85% RH**
- CE Mark**
- Rx ONLY** Prescription use only
- STERILE R** Sterilized by irradiation
- Importer**